

2.92mm/2.92mm

# DC - 40GHz, Coaxial Panel Adapters

## DESCRIPTION

These "KPC292MFPA,FFPA and MMPA" coaxial panel adapters that 9.5mm "D" holed panel mountable, low SWR and low loss, are designed for broadband measurement, instrument and system use.

## SPECIFICATIONS:

### Electrical:

|                   |                   |
|-------------------|-------------------|
| Frequency Range   | DC - 40 GHz       |
| SWR               | <1.15             |
| Insertion Loss    | <0.25 dB          |
| Electrical Length | Below (Nominal)   |
| Temperature Range | -55 to +125 deg.C |

### Mechanical:

|                         |                                  |
|-------------------------|----------------------------------|
| Body                    | : Passivated Stainless steel (*) |
| Outer Conductors        | : Gold Plated Stainless steel    |
| Inner Conductors        | : Gold Plated Beryllium Copper   |
| Coupling Torque         | : 90 N-cm(Nominal)               |
| Connect/Disconnect Life | : >1,000 Cycles                  |



**Production Status**  
Two weeks Lead-Time will be available for shipping.

### TYPE: KPC292MFPA

2.92mm Male/2.92mm Female

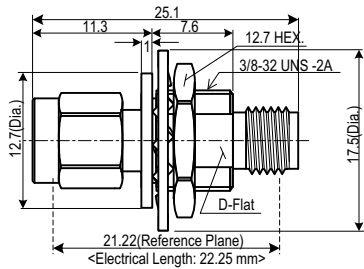

### Typical Performance

KPC292MFPA

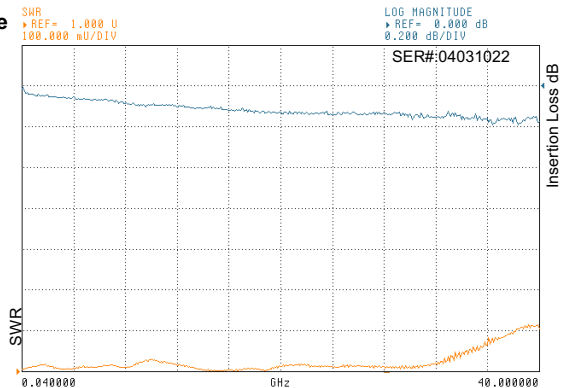

### TYPE: KPC292FFPA

2.92mm Female/2.92mm Female

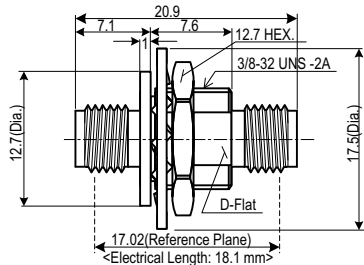

KPC292FFPA

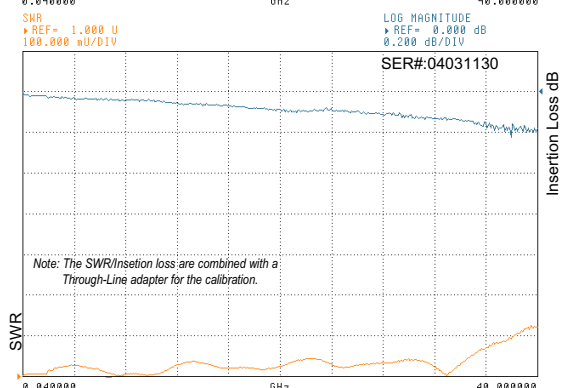

### TYPE: KPC292MMPA

2.92mm Male/2.92mm Male

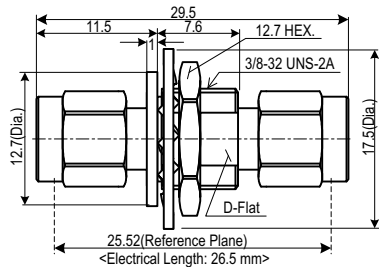

KPC292MMPA

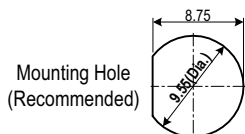
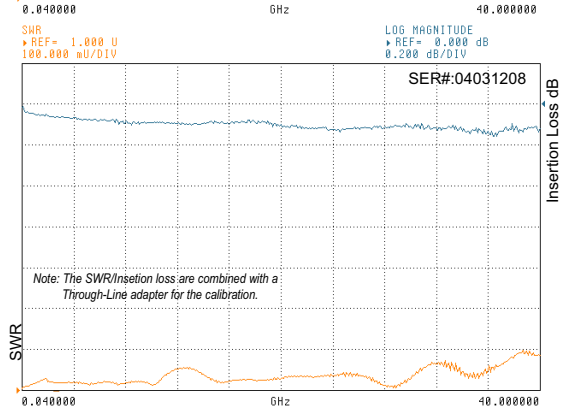

Note:  
- All dimensions are in Millimeters.  
- (\*)The toothed lockwasher is chromate converted zinc plated steel.

### Interface Mating Dimensions of KPC292 (2.92mm Connectors)

|   |         |
|---|---------|
| a | 1.270   |
| b | 2.920   |
| c | 4.640   |
| d | 4.580   |
| e | 0.920   |
| f | 0-0.050 |
| g | 0-0.050 |

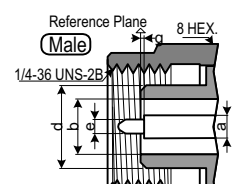
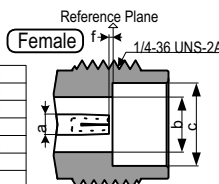

Specifications Subject to Change Without Notice.

Copyright(C) 2002-2004 KAWASHIMA Mfg. Co., Ltd. All rights reserved.

**KMCO** Kawashima Manufacturing Co., Ltd.

1-3-5 Higashiikuta, Tama-ku,  
Kawasaki 214-0031 JAPAN

TEL: +81-44-911-7073 FAX: +81-44-911-9621  
http://www.kmco.biz/ e-mail: sales@kmco.co.jp

292pa Rev. Mar.2004